

ABI 3400B Tailwheel Assembly Installation Instructions FAA-PMA

This ABI 3400B Assembly is an FAA-PMA part for installation with STC SA01636SE for aircraft listed on our FAA Approved Model List (AML). The installer is responsible for ensuring that the assembly is installed in accordance with the original equipment installation instructions.

Removal & Installation Instructions of ABI 3400B assembly:

- A)** Following airframe manufacturer's instructions, properly raise and support the tail of the aircraft off of the ground.
- B)** Disconnect & inspect the steering springs & chains from the tailwheel assembly.
- C)** Remove the old assembly from the tailspring, inspect the attach bolt and tail spring for correct arch. The center pivot spindle should angle back away from the airplane 5 to 7 degrees when un-loaded and be perpendicular to the ground at maximum gross weight. (Note: ABI recommends replacement of all attachment hardware.)
- D)** Re-install and adjust in reverse procedure, following the original airframe manufacturer's installation instructions. (NOTE: Tension on connector spring is not required or advisable. Over tension will create binding of the steering arm causing it to bend and damage internal parts. Connector springs and connector chain should be just slack. ABI recommends connecting the connector springs to an eye-bolt, not to the rudder arm.
- E)** All ABI 3400 series assemblies are pre-lubed at the factory with Exxon-Mobile SCH-100 grease. Over greasing of the axle will force the wheel seals (PN: ABI-1863) out against the bearing pre-load spacer (PN: ABI-3227-00) causing premature wear on the seals.

PMA Notice:

The ABI 3400B assembly carries a PMA marking, which identifies it as having been fully tested, inspected and qualified to meet the FAA specifications and requirements.

After final PMA approval, substitution of critical parts, change of process or materials is not permitted without re-qualification of parts and pieces and resubmitted to the FAA for approval. FAA regulations subject ABI, LLC PO Box 670989, 20130 Birchwood Spur Rd., Chugiak, AK 99567 and the user to constant surveillance that all quality assurance materials and processes contents are maintained in order to provide replacement parts that are the same as the Original Equipment parts in the assembly.

ABI-3400B Complete Assembly weight: 13.6lbs

ABI, LLC

PO Box 670989, 20130 Birchwood Spur Rd

info@airframesalaska.com 907-331-4480 www.airframesalaska.com

ITEM NO.	PART NUMBER	DESCRIPTION	QTY.
1	ABI-3412-M	ABI 3412 TAILWHEEL HEAD	1
2	ABI-3412-05	HEAD BOLT	1
4	ABI-3412-S.875	ABI-2412- HEAD SPACER .875	AR
5	ABI-3412-S.975	ABI-3412- HEAD SPACER .938	AR
6	ABI-3412-S.1.00	ABI-3412-HEAD SPACER 1.000	AR
7	08231	BEARING RACE	1
7	08118	BEARING	1
9	ABI-3233	SPRING	4
10	ABI-3411-02	UPPER DUST COVER	1
11	ABI-3408-00	THRUST WASHER	1
12	ABI-3408-01	FIBER THRUST WASHER, PHENOLIC .035	1
12	ABI-3410-03 OR ABI-3410-05	BENT STEERING ARM OR STRAIGHT STEERING ARM	1
14	ABI-3219-00 OR ABI-3219-02	PAWL	1
15	ABI-3407-00	SPACER	2
16	ABI-3408-02	FIBER THRUST WASHER, PHENOLIC .065	1
17	ABI-3411-01	LOWER DUST COVER	1
18	ABI-232-046	PIN	1
18	ABI-3432-00	SPRING	1
20	ABI-3258-01	SPACER	1
21	ABI-3258-00	SPACER	1
22	ABI-3257-00	PIN	1
23	A4138	BEARING RACE	3
24	A4050	BEARING	3
25	ABI-1863	GREASE RETAINER	3
26	ABI-2504-01	SPACER	1
27	NAS1149F0863P	WASHER	1
28	AN320-8	NUT	1
29	ABI-3244-00	WHEEL HALF	2
30	ABI-872	AXLE	1
31	ABI-3227	SPACER	2
32	NAS1149F0463P	WASHER	4
33	MS21044N4	NUT	4
34	ABI-3225-00	TAB LOCK WASHER	1
35	NAS1149F0832P	WASHER	1
36	AN310-8	NUT	1
37	MS24665-283	COTTER PIN	2
38	ABI-SP2	WHEEL SPACER	1
39	AN5-27A	BOLT	1
40	AN5-32A	BOLT	1
41	NAS1149F0563P	WASHER	2
42	NAS1149F0532P	WASHER	1
43	MS21044N5	NUT	2
44	1154.R OR 400X4	TIRE	1
45	ABI-SP34	SPACER PLATE	1
46	AN4-34A	BOLT	4
48	---	GREASE FITTING- STR 1/4-28 TAPER THD .55 HT	1
49	---	GREASE FITTING- 90° 1/4-28 TAPER THD .75 HT	1
50	MS24693-272	FLAT HEAD SCREW	3
51	ABI-F2	FORK	1

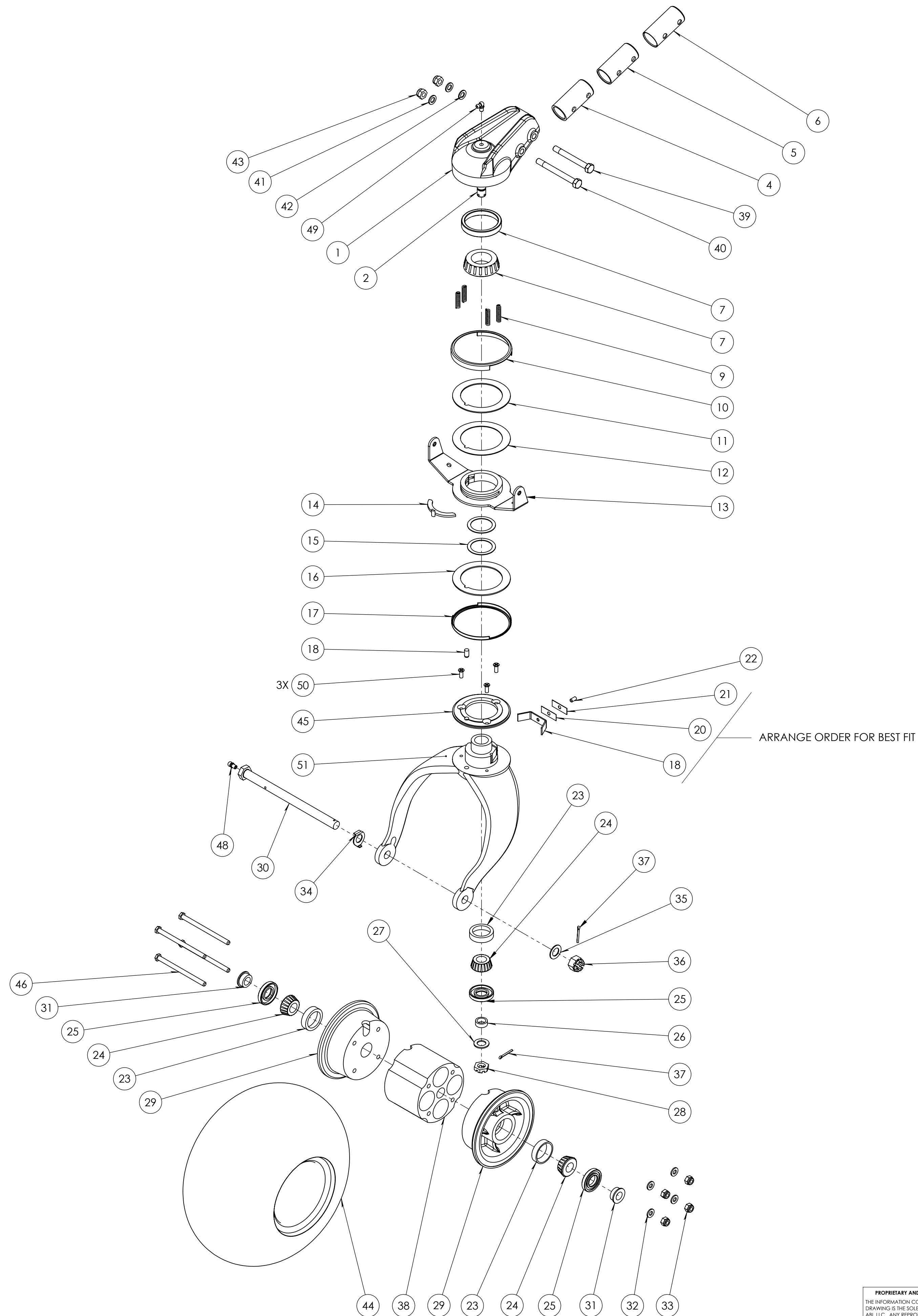

REVISIONS				
ZONE	REV.	DESCRIPTION	DATE	APPROVED
	G	UPDATED BOM ITEM #11	10/30/2008	ABI
	H	GENERAL UPDATE OF DRAWING; UPDATED VARIOUS HARDWARE P/N'S	3/10/2016	JLP

- NOTES:
- "AR" = ITEM QUANTITY "AS REQUIRED"
 - ITEM NUMBERS: 4, 5, AND 6 ARE OPTIONAL.

PROPRIETARY AND CONFIDENTIAL
THE INFORMATION CONTAINED IN THIS DRAWING IS THE SOLE PROPERTY OF ABI, LLC. ANY REPRODUCTION IN PART OR AS A WHOLE WITHOUT THE WRITTEN PERMISSION OF ABI, LLC IS PROHIBITED.

UNLESS OTHERWISE SPECIFIED: DIMENSIONS ARE IN INCHES TOLERANCES: X ± .125 XX ± .063 XXX ± .030		DRAWN JITZ	NAME JITZ	DATE 9/8/14
INTERPRET GEOMETRIC TOLERANCING PER: MATERIAL SEE BOM		ENG APPR.	MFG APPR.	G.A.
NEXT ASSY USED ON APPLICATION		COMMENTS:		
TITLE: TAILWHEEL AND FORK ASSY				REV H
SIZE DWG. NO. D ABI-3400B				SCALE: 1:10
SHEET 1 OF 1				

